

type 13142

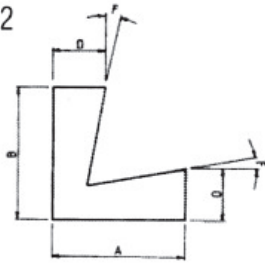

type 14177

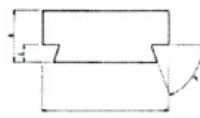

type 14718

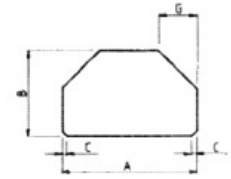

type 13200

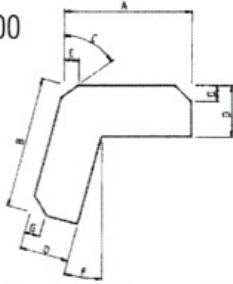

type 14405

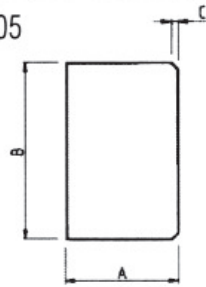

type 15691

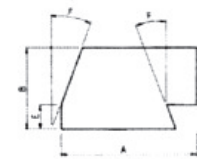

type 13233

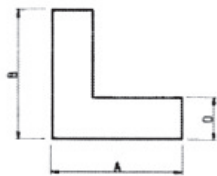

type 14717

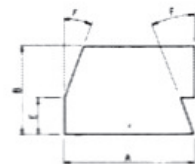

type 15825

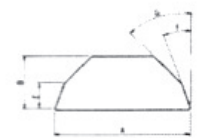

type 13946

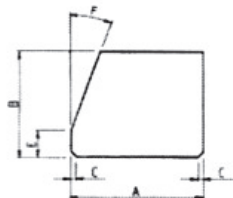

We produce all round, square and rectangular sizes.

profile-No	A width	B height	C chamfer	D thickness	E shouder/ teem	F angle	G angle 45°	H kg/m
13 142	38	38		17		10°		7,36
13 200	43,05	43,05	52° 30'	17	5	15°	5 x 45°	10,7
13 233	25	25		8				3,0
13 946	25	20	1 x 45°			20°		3,75
14 177	45	18			6	70°		6,65
14 405	16	25	1 x 45°					3,56
14 717	29	20			6	20°		4,69
14 718	25	16	1 x 45°				7 x 45°	3,12
15 691	32,5	20			6	20°		5,1
15 825	39,7	16			8	20°	10,5 x 45°	4,46